

CLARKE®

WOODWORKER



505MM CIRCULAR LOG SAW

MODEL NO: CLS505

PART NO: 3401999

ASSEMBLY & OPERATING INSTRUCTIONS

UK
PA | CE



ORIGINAL INSTRUCTIONS

DL1221 - ISS 2

INTRODUCTION

Thank you for purchasing this CLARKE Circular Log Saw.

Before attempting to use this product, please read this manual thoroughly and follow the instructions carefully. In doing so you will ensure the safety of yourself and that of others around you, and you can look forward to your purchase giving you long and satisfactory service.

When unpacking, check for damage or shortages etc. Any found should be reported to your CLARKE dealer where the product was originally purchased.

Please keep these instructions in a safe place for future reference.

OVERVIEW

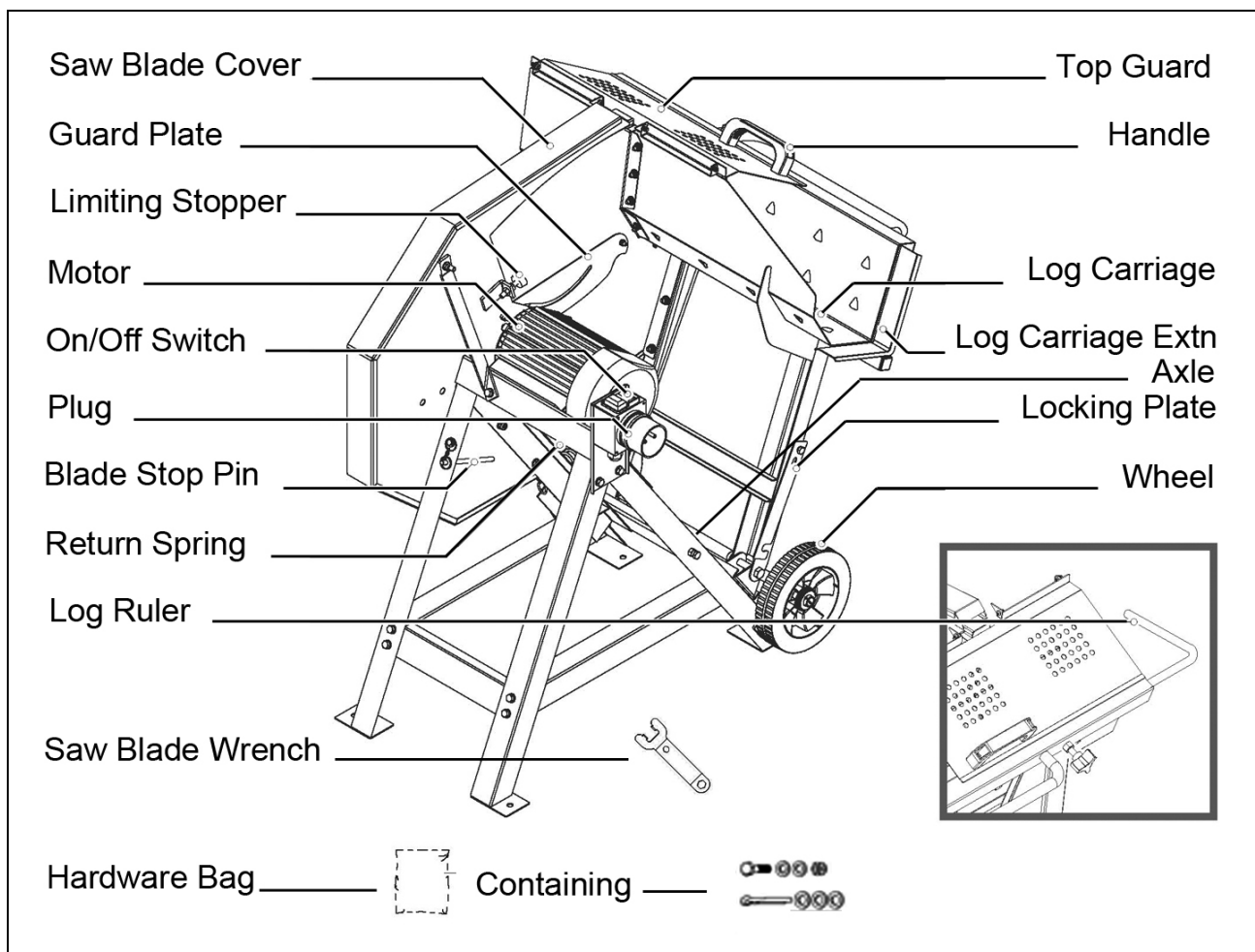

SPECIFICATIONS

Model Number	CLS505
Min/max Cutting Length	250 -1000 mm
Cutting Capacity (min/max dia)	30 - 170 mm
Max Wood Weight	16 kg
Operating Voltage	230V / 50Hz
Motor Power	3000 W
IP Rating	IP54
No load blade Speed	2800 rpm
Duty Cycle	S2 / 15 minutes
Blade Diameter	505 mm
Internal Bore Dia	30 mm
Teeth Thickness/Kerf	3.6 mm
No of Saw Teeth	40 HW
Sound Pressure Level	101 dB LpA
Guaranteed Sound Power Level	115 dB LWA
Product Dimensions: (L x W x H)	1015 (closed 980) x 809 x 994 mm
Weight	56.6 kg

SAFETY WARNINGS

WORK AREA

1. **Keep the work area clean and well lit.** Cluttered and dark areas invite accidents.
2. **DO NOT operate power tools in explosive atmospheres such as in the presence of flammable liquids, gasses or dust.** Power tools create sparks which may ignite dust or fumes.
3. **Keep children and bystanders away while operating any power tool.** Distractions can cause you to lose control.

ELECTRICAL SAFETY

1. **Power tools must match the power outlet. Never modify the plug in any way. Do not use adaptor plugs with earthed (grounded) power tools.** Correct plugs and outlets will reduce the risk of electric shock.
2. **DO NOT expose power tools to rain or wet conditions.** Any water entering power tools will increase the risk of electric shock.
3. **DO NOT abuse the electrical cable. Never use the cable for pulling or unplugging the power tool. Keep the cable away from sources of heat, oil, sharp edges or moving parts.** Damaged or tangled cables increase the risk of electric shock.
4. **Use outdoor extension leads.** If working outdoors, always use an approved cable extension suitable for the power rating of this tool (see specifications), the conductor size should also be at least the same size as that on the machine, or larger.
5. **When using a cable reel, always unwind the cable completely.** We strongly recommend that this machine is connected to the mains supply via a Residual Current Device (RCD).

PERSONAL SAFETY

1. **Stay alert, watch what you are doing and use common sense when you are operating a power tool.** Do not operate a power tool when you are tired, ill or under the influence of alcohol, drugs or medication. A moment of inattention may result in personal injury.
2. **Wear personal protective equipment including eye protection.** Safety equipment such as a dust mask, non-skid shoes or hearing protection used for appropriate conditions will reduce personal injuries. Use a face or dust mask if operation is particularly dusty. Wear ear protectors/defenders as the noise level of this machine can exceed 85dB.

3. **DO NOT over-reach.** Keep your proper footing and balance at all times. This enables better control of the power tool in unexpected situations.
4. **Concentrate on the job in hand, no matter how trivial it may seem.** Be aware that accidents are caused by carelessness due to familiarity.
5. **Avoid accidental starting of the machine.** Ensure the switch is in the off position before plugging the machine in to the power supply. Plugging in power tools that are switched on invites accidents.
6. **Dress properly.** Do not wear loose clothing or jewelry which may get caught in moving parts. Wear protective hair covering to contain long hair. For best footing, wear protective footwear. Keep floor clear of oil, scrap wood, etc.
7. Wear gloves while handling saw blades and always store them in the protective packing provided. A dust mask should be worn to reduce the inhalation of harmful dust.
8. **ALWAYS** remove and stack cut timber in a suitable place, well away from the saw operator.
9. Switch the machine OFF immediately after the task is completed.

POWER TOOL USE AND CARE

1. **DO NOT force the power tool.** Use the correct accessories for your application. The power tool will do a better and safer job at the rate for which it was designed.
2. **DO NOT use the power tool if the switch does not turn it on and off.** Any power tool that cannot be controlled with the switch is dangerous and must be repaired.
3. **Disconnect the power tool from the power supply before making any adjustments or storing the tool.** These measures will reduce the risk of the power tool starting accidentally.
4. **Store power tools out of the reach of children and do not allow persons unfamiliar with these instructions to operate this product.** Power tools are potentially dangerous in the hands of untrained users.
5. **Maintain power tools in top condition.** Check for misalignment or binding of moving parts, broken parts, or any condition that may affect the machine's operation. If damaged, have the machine repaired before use. Many accidents are caused by poorly maintained power tools.
6. **Check the power tool for damage before use.** Any damaged part should be inspected to ensure that it will operate properly and perform its intended function. Any damage should be properly repaired or the part replaced. If in doubt, **DO NOT** use the machine. Consult your local dealer.

SERVICING

1. **When necessary, have your power tools serviced or repaired by a qualified person using identical replacement parts.** This will ensure that the safety of the power tool is maintained.

PRECAUTIONS SPECIFIC TO CIRCULAR SAWS

1. **ALWAYS** wear ear protectors/defenders during continuous use as the noise level of this machine can exceed 85dB (A).
2. **ALWAYS** keep the mains cable well away from the saw and ensure an adequate electrical supply is close at hand so that the operation is not restricted by the length of the cable.
3. **ALWAYS** use only the correct blade for this saw and ensure the blade is fully tightened before use. The blade must always be rated to operate at a rotational speed equal to, or greater than that of the machine.
4. Beware of foreign objects. When cutting pre-used wood, ensure all nails have been removed beforehand. Nails will damage the saw blade.
5. When switching off, remember that the blade will continue to rotate for a short time after the stop button has been pressed to stop the saw.
6. **NEVER** operate the saw without the blade guards being installed correctly.
7. **NEVER** operate the saw without the removable blade guard being installed correctly.
8. **NEVER** start the saw when the blade is in contact with the work.
9. **DO NOT** use the saw if the power cable, plug or motor is in poor condition.
10. **ALWAYS** ensure the workpiece is held securely when cutting by placing securely in the log cradle to avoid loss of control.
11. **ALWAYS** hold the cradle handles with both hands to keep hands well away from the saw blade.
12. **DO NOT** attempt to saw very small logs including those which cannot be properly secured. Logs sizes are stated in the Specification on page 3.

CHANGING BLADES

1. Unplug the saw from the power supply before changing blades and take care to prevent entrapment of the fingers between the blade and the inner guard. Ensure the blade is secure before use.
2. Use the appropriate saw blade for this saw. Correct blades are available from your CLARKE dealer Part No 3401994.
3. **ONLY** use saw blades in good working condition. Discard and replace cracked or bent saw blades.
4. **ALWAYS** secure the blade using the wrenches supplied.

SAFETY SYMBOLS & PICTOGRAMS

Please read all of the safety and operating instructions carefully before using this product.

The following safety symbols are found on the product.

	Refer to instruction manual before use.		NEVER reach into the running saw blade.
	Wear eye protection		Wear a breathing mask
	Wear ear protection		DO NOT use in the rain.
	Wear protective gloves		Keep hands away from the blade or serious personnel injury could result.
	Wear safety footwear		Disconnect mains power cable prior to any repair, cleaning or maintenance.
	Keep children and bystanders away		NEVER attempt to cut more than one log at a time.
	Inspect the log cutter for damage before use.		Avoid accidents by keeping work space tidy.

ELECTRICAL CONNECTIONS



WARNING: READ THESE ELECTRICAL SAFETY INSTRUCTIONS THOROUGHLY BEFORE CONNECTING THE PRODUCT TO THE MAINS SUPPLY.

Connect the mains lead to a standard, 230 Volt (50Hz) electrical supply through an approved 13 amp BS1363 plug, or a suitably fused isolator switch.

If the plug has to be changed because it is not suitable for your socket or because of damage, it must be removed and a replacement fitted, following the wiring instructions shown below. The old plug must be discarded safely as insertion into a power socket could cause an electrical hazard.



**WARNING: THE WIRES IN THE POWER CABLE OF THIS PRODUCT ARE COLOURED IN ACCORDANCE WITH THE FOLLOWING CODE:
BLUE = NEUTRAL BROWN = LIVE YELLOW AND GREEN = EARTH.**

The If the colours of the wires in the power cable do not correspond with the markings on the terminals of your plug, proceed as follows.

- Connect the **blue** wire to the terminal which is marked **N**.
- Connect the **brown** wire to the terminal which is marked **L**.
- Connect the **yellow and green** wire to the terminal which is marked **E** or \perp .

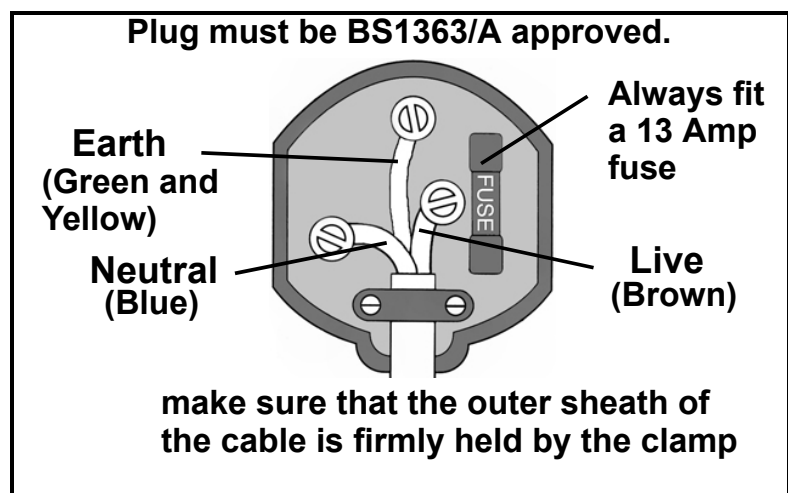

We strongly recommend that this machine is connected to the mains supply via a Residual Current Device (RCD). If you are not sure, consult a qualified electrician. **DO NOT** try to carry out any repairs yourself.

INVENTORY

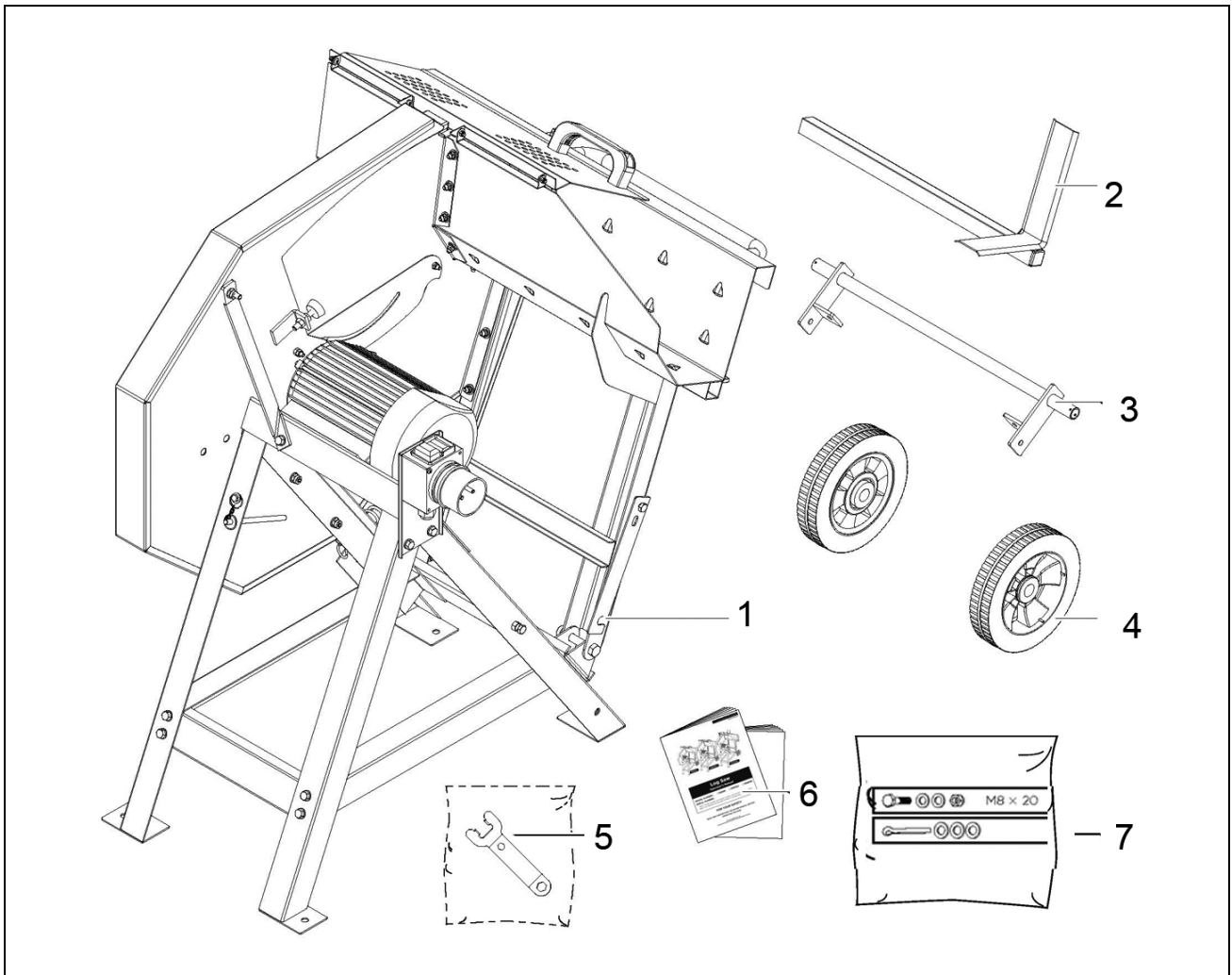

1	Base Frame & Motor
2	Log Carriage Extension
3	Wheel Axle
4	Wheels (x2)

5	Blade Wrench M12
6	User manual (this document)
7	Hardware Bag

ASSEMBLY

This log saw was partially assembled at the factory. To complete your saw follow the instructions below.

AXLE

Put the axle on the rear of the base frame and align the holes as shown. Secure it with four bolts M8 x 20, washer and nuts on both sides as shown in Fig A.

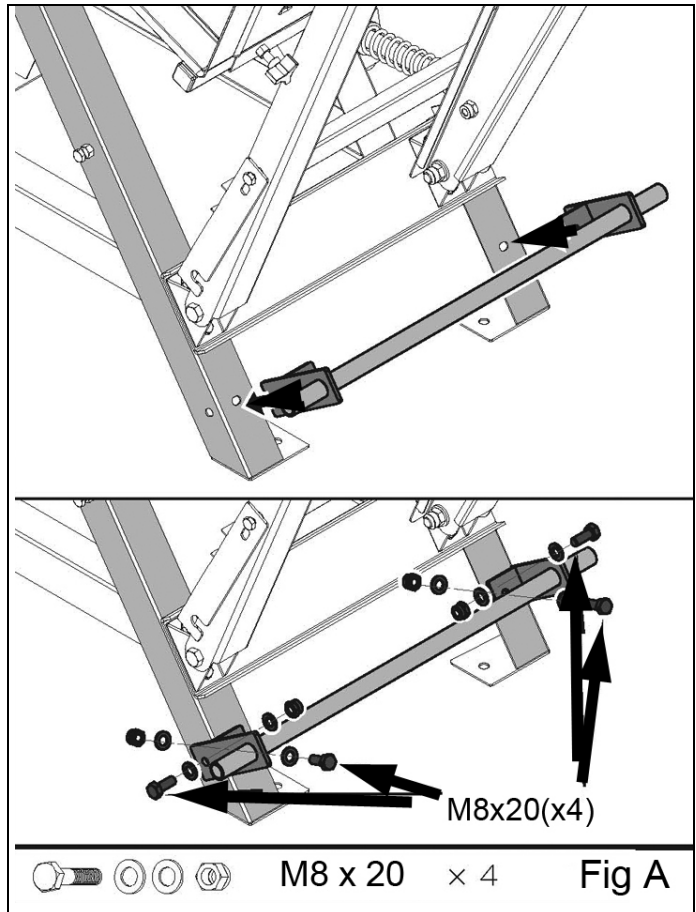

WHEELS

Slide two washers, a wheel and a third washer onto the axle. Insert the cotter pin into the holes of the wheel axle and split it to secure the wheel. Repeat for the other wheel as shown in Fig B.

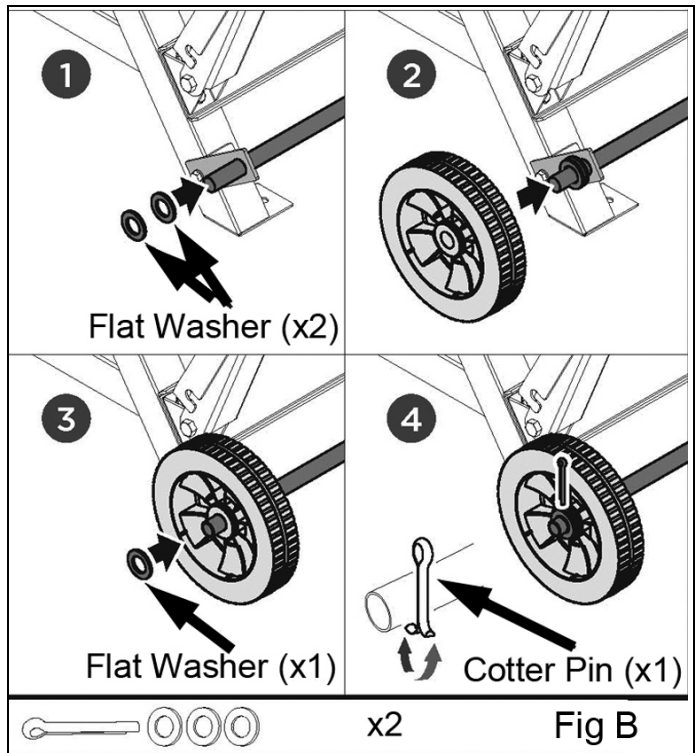

LOG CARRIAGE EXTENSION

Loosen the adjusting wingbolt on the back of the log carriage until the extension can be inserted into the opening. Slide the log carriage extension into the channel and align it correctly, then tighten it with a wing bolt as shown in Fig C.

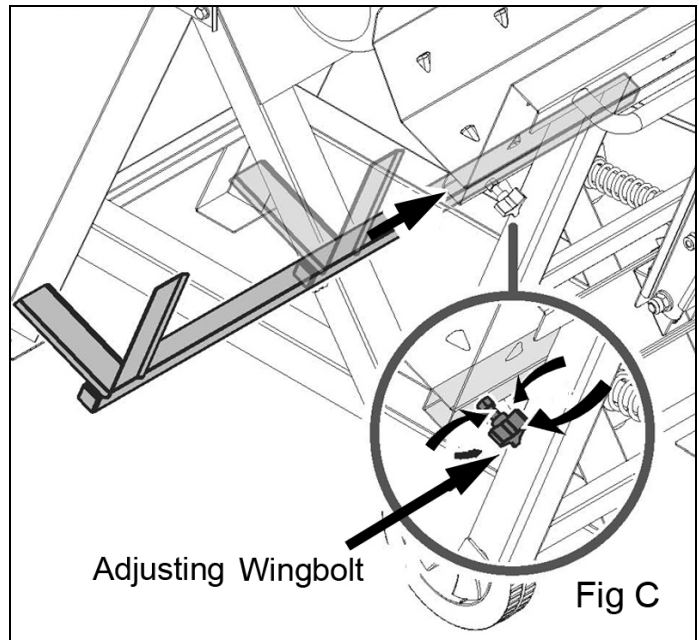

MOUNTING THE SAW TO THE FLOOR

The foot of each leg is provided with an 8mm bolt hole for fixing the log saw to a suitably level floor or platform. Choose a suitable position close to a convenient power supply and bolt or screw the stand securely in position as shown in Fig D. (fixings not supplied).

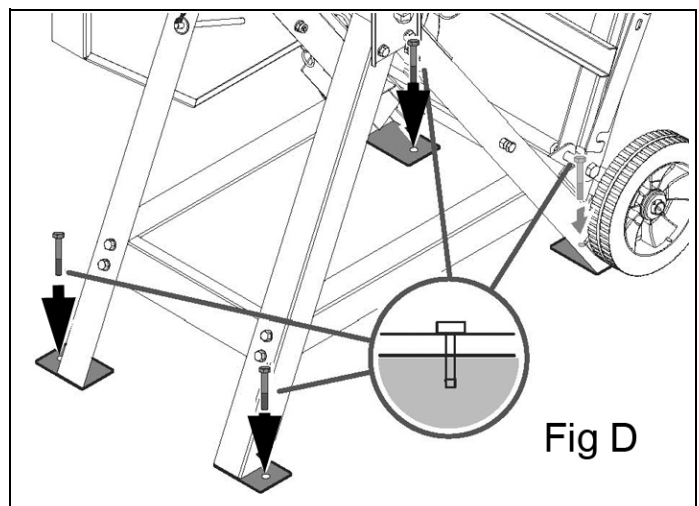

SET THE LOG RULER

Loosen the wing bolt M5 x 20 to allow the log ruler to be pulled out freely. Set the desired length on the scale. Turn it clockwise as shown in step 3 and secure by tightening the wing bolt as shown in Fig E.

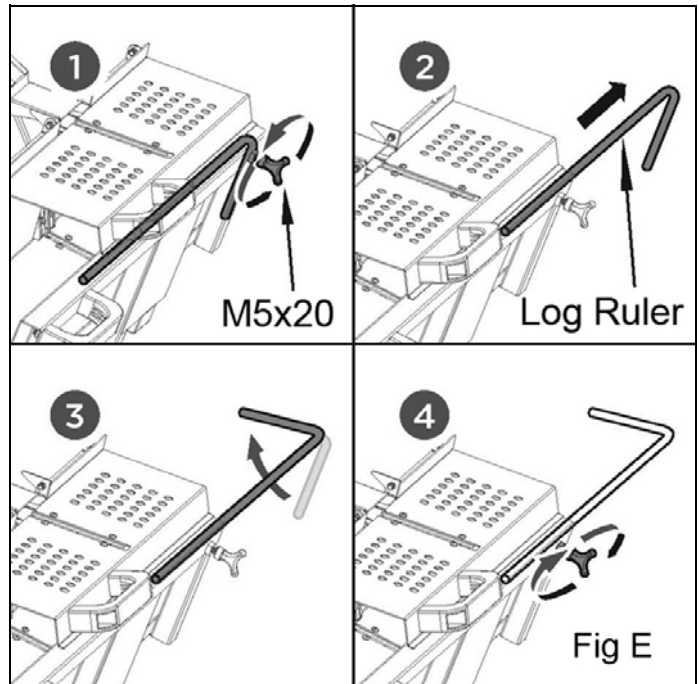

OPERATION

1. Check that all component parts are secure. If the log saw is not fixed to the floor, ensure that it is placed in a steady position on firm ground.
2. Ensure the power cable is well away from the saw and the workpiece, then plug into the mains supply.
3. Check that any previously used timber being sawn does not contain any nails or other metal objects which would damage the blade.
4. ALWAYS check that the saw guard and cradle move freely and spring back when released.
 - The maximum log diameter that can be cut is 170mm, max weight 16kg.

USING THE SAW

1. Turn on the motor switch
 - Once motor switch is set to ON the blade starts rotating.
2. Open the top guard, place the log to the cutting position on the log carriage and close the guard. Position the log so that it will not move while cutting.
3. If the length of the log is greater than the length of the cradle, extend the log support yoke and set it's position to suit with the securing knob.
4. Grip the handle at the left side of log carriage and push it towards the saw blade cover.
 - The movable saw blade guard will open and expose the saw blade.
5. Keep pushing with even pressure until the log on the log carriage is cut. Avoid putting unnecessary pressure on the blade and avoid applying lateral pressure. Let the blade work naturally.
6. Stop pushing and the log carriage will retract to its original position. Move the rest of log to the cutting position and continue next cycle until the work is accomplished.
7. Regardless of the diameter of the wood, only one piece should be placed on the cradle for cutting at anyone time. Do not attempt to saw multiple pieces at once.
8. If logs of equal length are required, set the log stop bar to the required distance. Measure this against the scale on the cradle and lock in position with the securing knob provided.

9. ALWAYS control the cradle, keeping both hands on the handles provided. When pushing the logs into the saw, take care that the motor speed does not drop.
10. To stop the saw press the OFF switch. ALWAYS switch off before unplugging and never leave the saw running unattended.
11. Avoid putting unnecessary pressure on the blade. Let the blade work naturally.
12. NEVER try to re-start the saw if the blade becomes jammed in the log. Switch off and release the jammed log first.

TRANSPORTING THE SAW

The log saw is equipped with two wheels for easy transportation.



CAUTION: DO NOT TRANSPORT THE SAW WITH LOGS ALREADY LOADED.

1. Push the log carriage towards the motor until it touches the limiting stop as shown in Fig F.

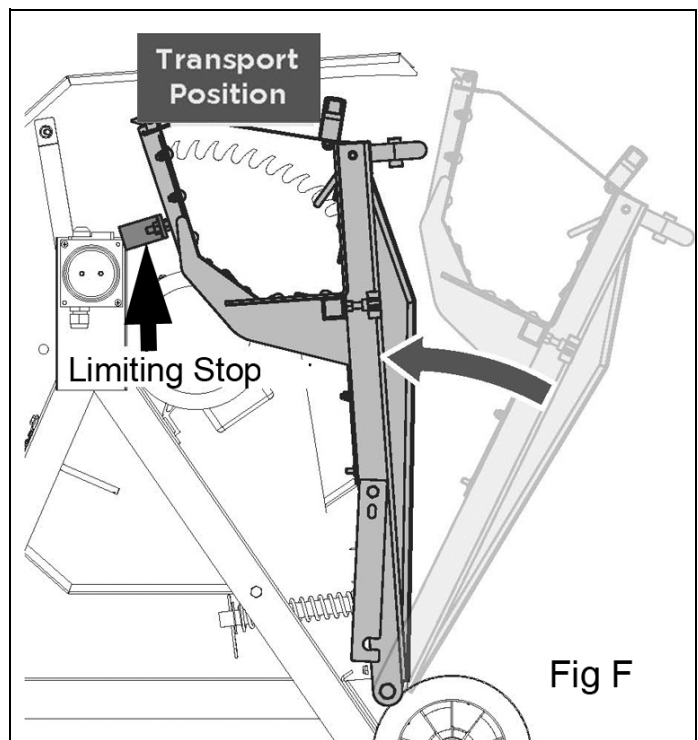

- Secure it with the locking plateas shown in Fig G.

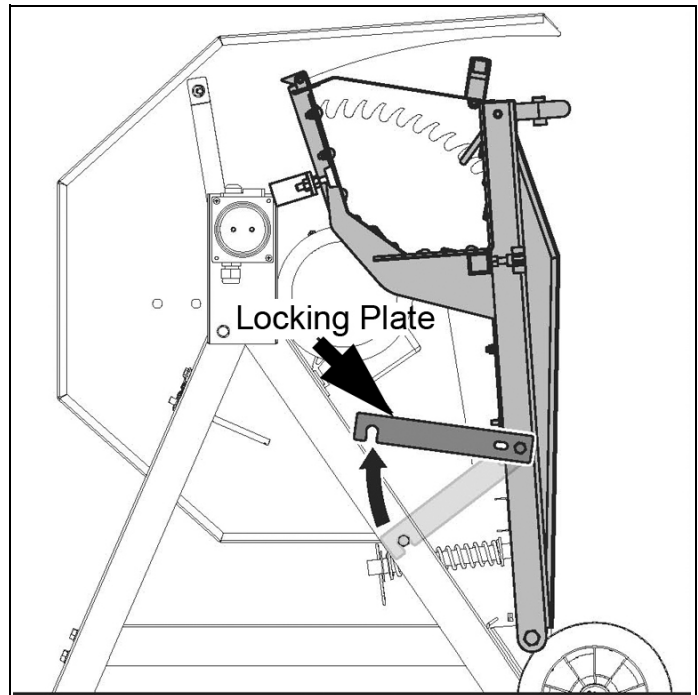

Attention! The locking plate must be released before sawing! Fig G

- Stand behind the unit and tip it towards you for easy transport as shown in Fig H.

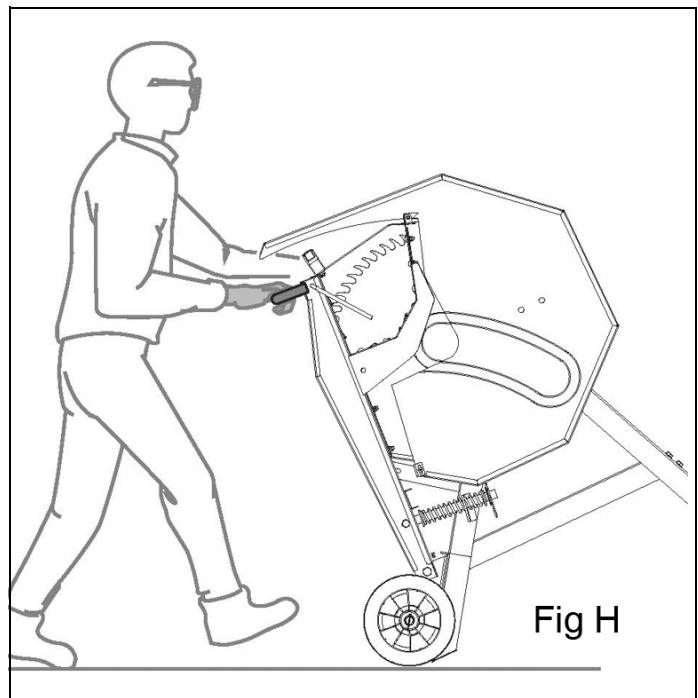

MAINTENANCE

1. ALWAYS inspect the saw before use and ensure it is in top condition.
2. Ensure that the guard can spring freely back to its closed position and clean out any debris lodged behind it.
3. Check the power cable to ensure it is sound and free from cracks, bare wires etc.
4. After use, clean all dust and wood chippings from the saw and its hinged parts and guards.
5. Ensure motor air vents are clear of debris, (use compressed air to clean the machine if possible). If using compressed air always wear goggles and a dust mask.
6. For any problems requiring the dismantling and overhaul of the saw, contact your CLARKE International Service Department on 020-8988-7400.

STORAGE

1. Store in a clean, dry environment protected from the weather and away from children and untrained users.

CHANGING THE SAW BLADE



CAUTION: ONLY USE SAW BLADES WITH THE CORRECT FITTING AS SUPPLIED. ALWAYS ENSURE THE SAW IS DISCONNECTED FROM THE POWER SUPPLY BEFORE INSTALLING/REMOVING THE BLADE.

1. Ensure the saw is disconnected from the power supply. Take care that the saw blade has cooled down before touching if it has just been in use.

SAW BLADE CHANGE

1. Remove the M5 nut and flat washers from the guard plate as shown in Fig I.

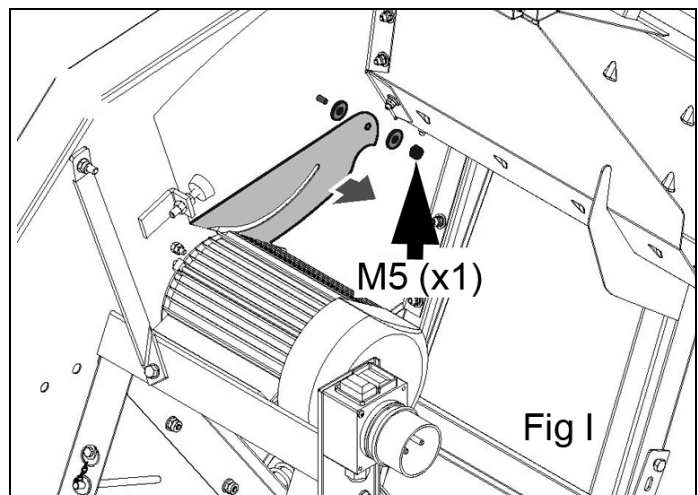

2. Ensure the weight of the carriage is supported.
3. Pull the R-clip and washer from the return guide tube as shown in Fig J.

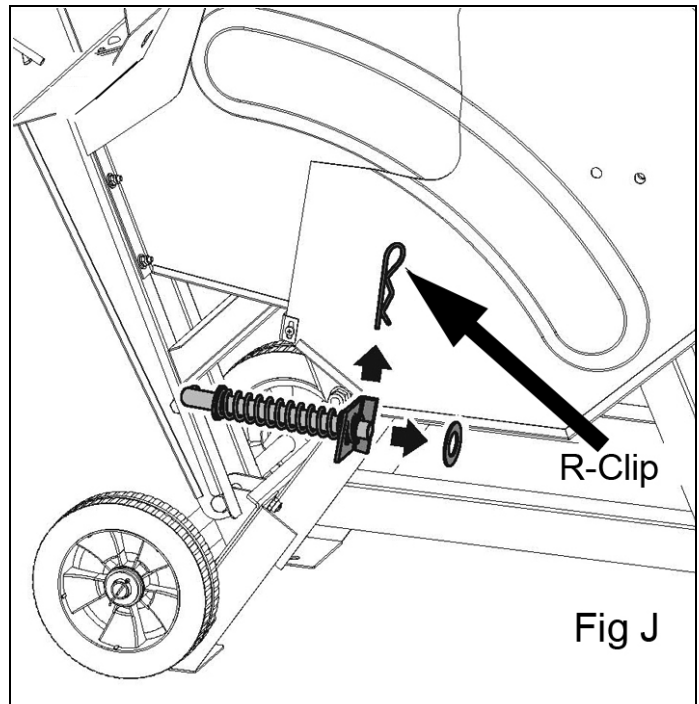

4. Lower the log carriage towards the ground as shown in Fig K.

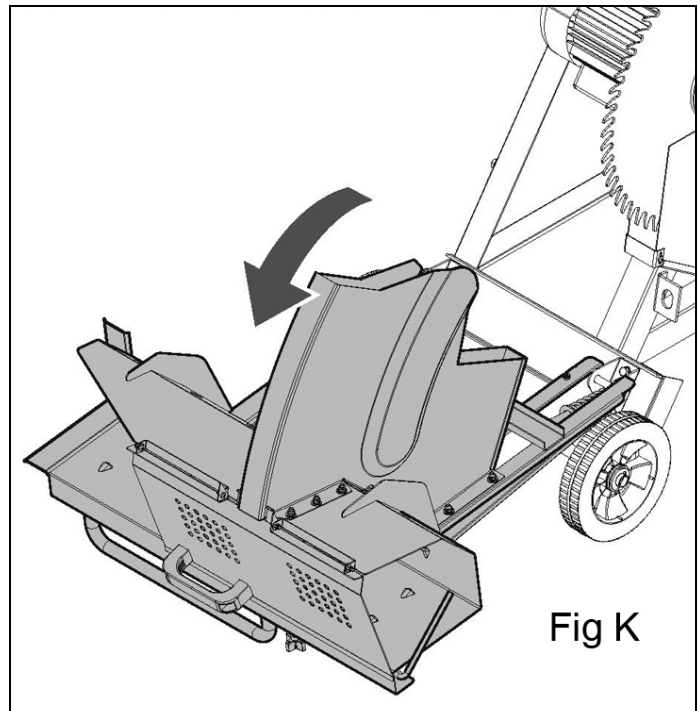

5. Loosen the fixing bolt to release the ring end of the chain for the stop pin.
6. Pull the stop pin out of the baseframe.
7. Insert the lockpin into the hole at the saw blade cover to block the blade from rotating as shown in Fig L.

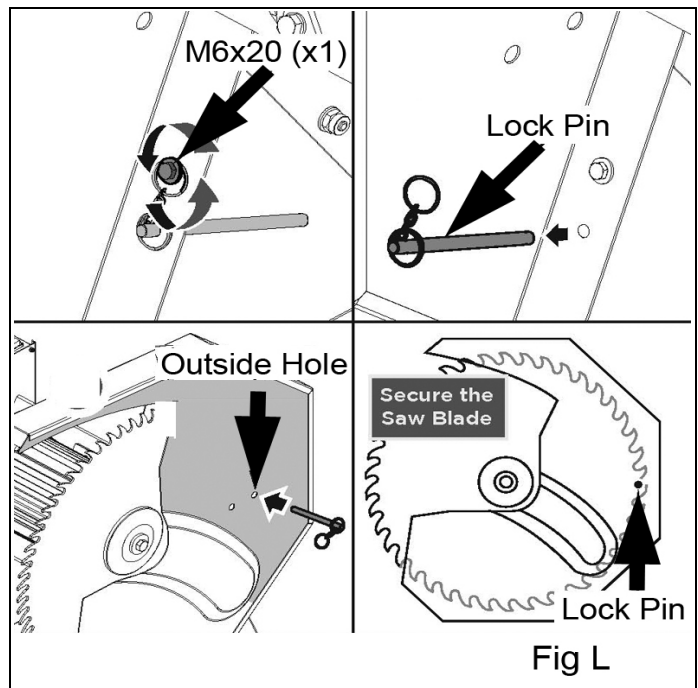

8. Loosen and remove the bolt M12 x 30 with the wrench supplied. Remove the washer and front retaining disc to remove the saw blade.
9. Replace all components in reverse order as shown in Fig M

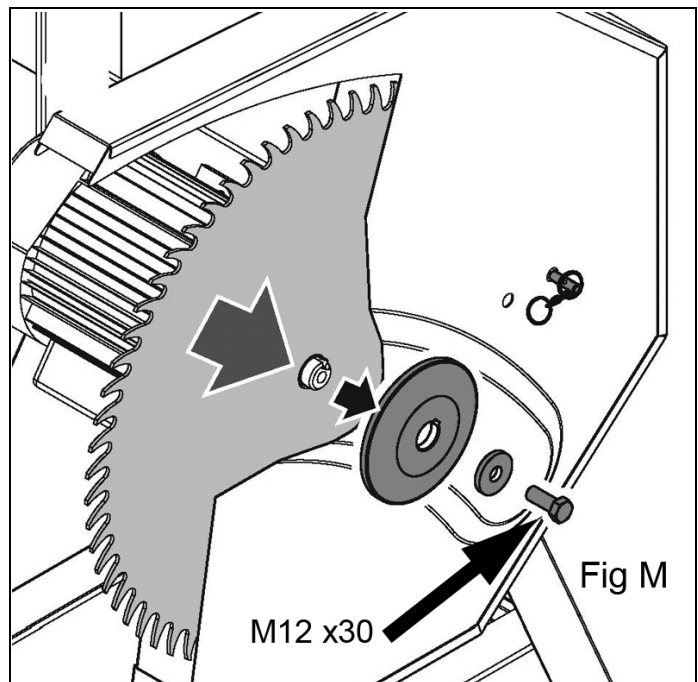

CAUTION: INSTALLING THE BLADE THE WRONG WAY ROUND WILL RESULT IN DAMAGE TO THE BLADE.

SHARPENING THE BLADE

The saw blade can be sharpened several times without removing it from the machine. Use a fine cut square bladed file of 8-12" for sharpening.

When sharpening manually, only file the front rake of each tooth over a distance of about 5-7mm.

ALWAYS keep the original shape of the tooth. Take care not to make sharp notches at the root of the tooth with your file.

Check the blade carefully for cracks.

NOTE: Replacement blades are available from your CLARKE dealer as Part No 3401994.

FAULT FINDING

Problem	Cause	Solution
Machine will not operate.	No power supply.	Check supply and rectify.
	Switch is faulty.	Consult your CLARKE dealer.
	Fuse in plug has blown.	Check and replace.
	Motor is faulty.	Consult your CLARKE dealer.
Motor becomes hot.	Unduly heavy use.	Reduce the force applied to the saw. Let the machine do the work.
	Air vents have become blocked.	Clean out air vents using compressed air or clean with a dry cloth.
	Low supply voltage.	Ensure supply voltage is correct. If an extension cable is used, ensure it is of the correct rating and is fully unwound.
Heavy internal sparking.	Motor fault such as worn brushes.	Return to your CLARKE dealer for repair.
Excessive vibration	Blade not mounted correctly.	Check seating of blade and securing discs, and tightness of retaining nut.
	Saw motor bearings worn.	Return to your CLARKE dealer for repair.
Burns showing on the cut timber.	Incorrect or blunt saw blade.	Replace blade with the correct replacement. Check and tighten blade as necessary.

COMPONENT PARTS

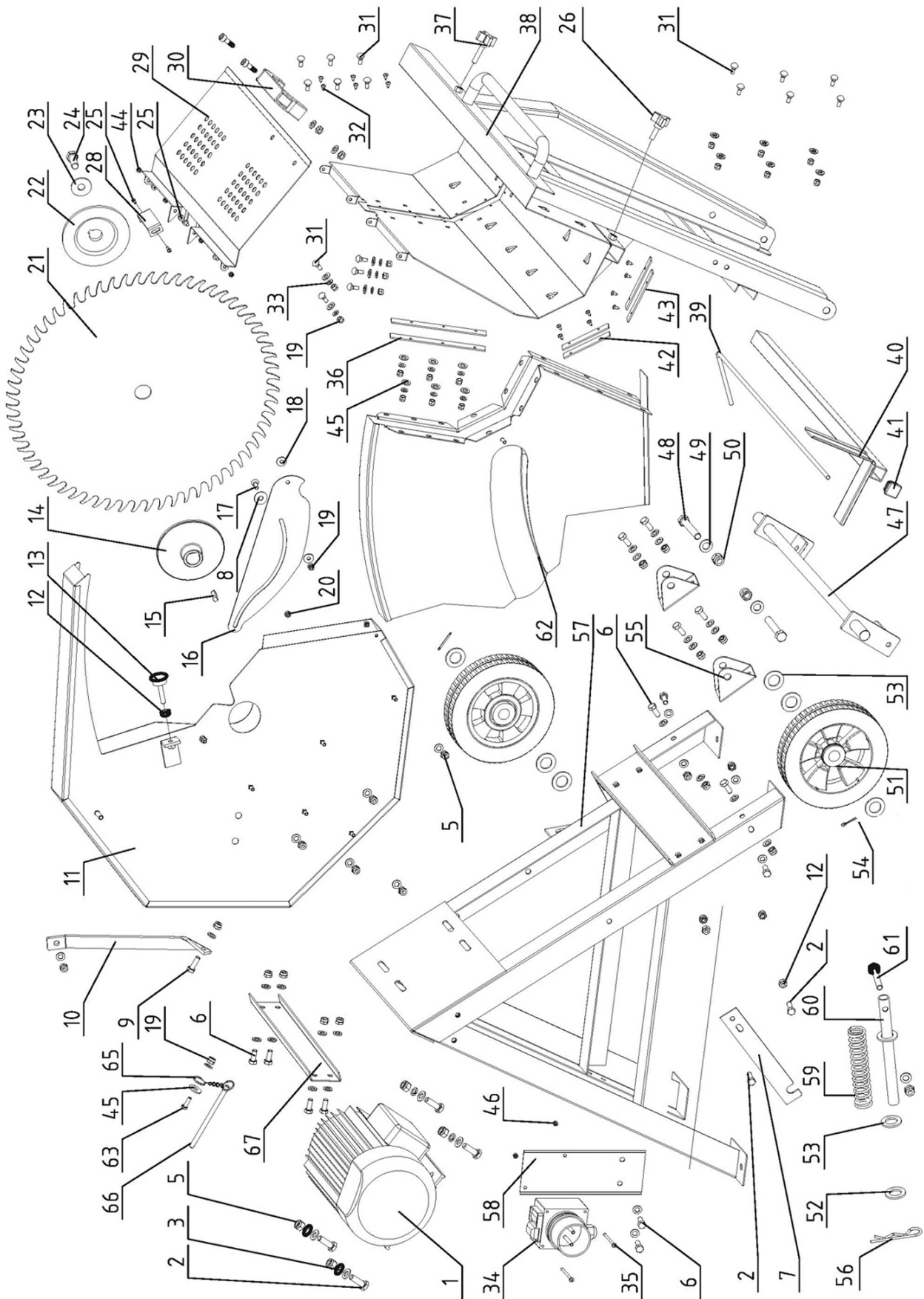

PARTS LIST

No	Description
1	Motor
2	Bolt M8 x 25
3	Flat washer
4	n/a
5	Locknut M8
6	Bolt M8 x 20
7	Locking plate
8	Vibration absorbing washer
9	Bolt M8 x 25
10	Support plate
11	Saw blade cover
12	Nut M8
13	Bolt M8 x 40
14	Rear blade retaining disc
15	Key 8 x 7 x 30
16	Movable guard plate
17	Bolt M6 x 25
18	Large washer
19	Locknut M6
20	Nut M6
21	Saw blade
22	Front blade retaining disc
23	Large washer 12
24	Bolt M12 x 30
25	Screw M5 x 10
26	Wingbolt
27	N/a
28	Limit plate
29	Top Guard
30	Handle
31	Bolt M6 x 16
32	Screw st 4.2x9.5
33	Flat washer 6
34	Switch

No	Description
35	Screw M4 x 60
36	Plastic wear strip 3
37	Square wingbolt
38	Log carriage
39	Log ruler
40	Log carriage extension
41	Plug for 25 mm section
42	Plastic wearstrip 2
43	Plastic wearstrip 1
44	Locknut M5
45	Large washer
46	Locknut M4
47	Axle
48	Bolt M12 x 70
49	Flat washer 12
50	Locknut M12
51	Wheel 8"
52	Washer
53	Washer 20
54	Cotter pin 2.5 x 32
55	Fixing lug
56	R-Clip 3
57	Base frame
58	Switch mounting bracket
59	Return spring
60	Guide tube
61	Bolt M10 x 60
62	Blade guard
63	Bolt M6 x 20
64	N/a
65	Locking chain
66	Blade stop pin
67	Connecting plate

GUARANTEE

This product is guaranteed against faulty manufacture for a period of 12 months from the date of purchase. Please keep your receipt which will be required as proof of purchase.

This guarantee is invalid if the product is found to have been abused or tampered with in any way, or not used for the purpose for which it was intended.

Faulty goods should be returned to their place of purchase, no product can be returned to us without prior permission.

This guarantee does not effect your statutory rights.

ENVIRONMENTAL RECYCLING POLICY







Through purchase of this product, the customer is taking on the obligation to deal with the WEEE in accordance with the WEEE regulations in relation to the treatment, recycling & recovery and environmentally sound disposal of the WEEE.

In effect, this means that this product must not be disposed of with general household waste. It must be disposed of according to the laws governing Waste Electrical and Electronic Equipment (WEEE) at a recognised disposal facility.

If disposing of this product or any damaged components, do not dispose of with general waste. This product contains valuable raw materials. Metal products should be taken to your local civic amenity site for recycling of metal products.

DECLARATION OF CONFORMITY

 Clarke [®] INTERNATIONAL Hemmill Street, Epping, Essex CM16 4LG	DECLARATION OF CONFORMITY This is an important document and should be retained.
We hereby declare that this product(s) complies with the following statutory requirement(s): <i>Electromagnetic Compatibility Regulations 2016</i> <i>Supply of Machinery (Safety) Regulations 2008</i> <i>The Restriction of the Use of Certain Hazardous Substances in Electrical and Electronic Equipment Regulations 2012</i>	
The following standards have been applied to the product(s): EN 55014-1:2017+A11, EN 55014-2:2015, EN 61000-3-2:2019, EN 61000-3-3:2013+A1, EN 60204-1:2018, EN 1870-6:2017, EN ISO 13849-1:2015, EN ISO 12100:2010, IEC 62321-3-1:2017, IEC 62321-4:2013+AMD1:2017, IEC 62321-5:2013, IEC 62321-6:2015, IEC 62321-7-1:2015, IEC 62321-7-2:2015, EN ISO 17075:2017.	
The technical documentation required to demonstrate that the product(s) meet(s) the requirement(s) of the aforementioned legislation has been compiled and is available for inspection by the relevant enforcement authorities.	
The UKCA mark was first applied in: 2021	
Product Description: 505mm Circular Log Saw Model number(s): CLS505 Serial / batch Number: N/A Date of issue: 07/12/2021	
Signed:  J.A. Clarke Director	
CLS505 UKCA Clarke DOC 120721	

 Clarke [®] INTERNATIONAL Fitzwilliam Hall, Fitzwilliam Place, Dublin 2	DECLARATION OF CONFORMITY This is an important document and should be retained.
We hereby declare that this product(s) complies with the following directive(s): <i>2014/30/EU Electromagnetic Compatibility Directive.</i> <i>2006/42/EC Machinery Directive.</i> <i>2011/65/EU Restriction of Hazardous Substances, (amended by 2015/863).</i>	
The following standards have been applied to the product(s): EN 55014-1:2017, EN 55014-2:2015, EN 61000-3-2:2014, EN 61000-3-3:2013, EN 60204-1:2018, EN 1870-6:2017, IEC 62321-3-1:2017, IEC 62321-4:2013+AMD1:2017, IEC 62321-5:2013, IEC 62321-6:2015, IEC 62321-7-1:2015, IEC 62321-7-2:2015, EN ISO 17075:2017.	
The technical documentation required to demonstrate that the product(s) meet(s) the requirement(s) of the aforementioned directive(s) has been compiled and is available for inspection by the relevant enforcement authorities.	
The CE mark was first applied in: 2020	
Product Description: 505mm Circular Log Saw Model number(s): CLS505 Serial / batch Number: N/A Date of issue: 07/12/2021	
Signed:  J.A. Clarke Director	
CLS505 CE Clarke DOC 120721	

A SELECTION FROM THE VAST RANGE OF

Clarke®

QUALITY PRODUCTS



AIR COMPRESSORS

From DIY to industrial, Plus air tools, spray guns and accessories.

GENERATORS

Prime duty or emergency standby for business, home and leisure.

POWER WASHERS

Hot and cold, electric and engine driven - we have what you need

WELDERS

Mig, Arc, Tig and Spot. From DIY to auto/industrial.

METALWORKING

Drills, grinders and saws for DIY and professional use.

WOODWORKING

Saws, sanders, lathes, mortisers and dust extraction.

HYDRAULICS

Cranes, body repair kits, transmission jacks for all types of workshop use.

WATER PUMPS

Submersible, electric and engine driven for DIY, agriculture and industry.

POWERTOOLS

Angle grinders, cordless drill sets, saws and sanders.

STARTERS/CHARGERS

All sizes for car and commercial use.

PARTS & SERVICE: 0208 988 7400

Parts Enquiries
Parts@clarkeinternational.com

Servicing & Technical Enquiries
Service@clarkeinternational.com

SALES: UK 01992 565333 or Export 00 44 (0)1992 565335

Clarke INTERNATIONAL Hemnall Street, Epping, Essex CM16 4LG
www.clarkeinternational.com